

Festive Friends Table Runner Three

Designed by Hazel Jeffrey

Size 58" x 23"

All fabrics are from Festive Friends by Fabric Freedom

Please read through all the instructions before you begin

Requirements

1. FF300-3 Festive Friends 1/4 yard – 25cm
2. FF301-3 Birds all in a row 3/8 yard – 40cm
3. FF302-3 Christmas puddings 1/2 yard – 50cm
4. FF303-3 Mistletoe 3/8 yard – 40cm
5. FF304-3 Christmas Trees 1/2 yard – 50cm
6. White 1/2 yard – 50cm
7. For the backing use fabric 1: 1.1/2 yards – 1.5 mtr
8. For the binding use fabric 2: 1/4 yard – 25cm

You will also need a piece of wadding approximately 62" x 27".

Cutting

From fabric 1 first cut two 27" pieces the width of the fabric remove the selvedge and sew together to make a 62" by 27" rectangle for the backing, from the remaining fabric cut three 6.1/2" squares

Fabric 2 cut twelve 3.7/8" squares, twelve 3.1/2" squares

From fabric 3 cut and piece 2.1/2" wide strips, two 23.1/2" long and two 58.1/2" long for the border

From fabric 4 cut twelve 3.1/2" squares and twelve 3.7/8" squares

From fabric 5 cut twenty four 3.7/8" squares

From fabric 6 cut twelve 3.1/2" squares and twenty four 3.7/8" squares

For the binding cut four 2.1/2" lengths of fabric 2 across the width of fabric.

All measurements include 1/4" seam allowances.

Sewing

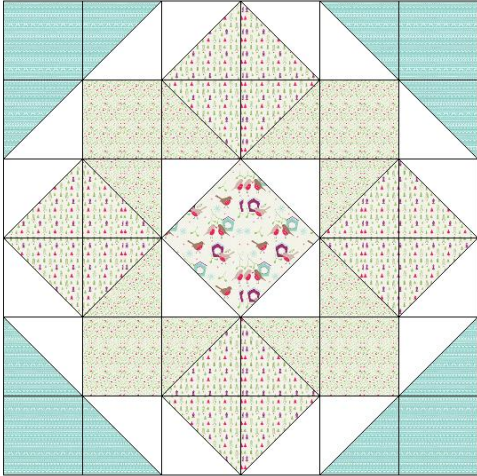

Make half square triangle units using the 3.7/8" squares in fabric 2 with fabric 6, fabrics 4 and 5 and fabrics 5 and 6. Place two squares with right sides together and mark a line along the diagonal. Sew a 1/4" seam either side of the marked line. Cut along the line to produce two half square triangle units from each pair of squares.

Use four squares each of fabrics 2 and white together.

Use four squares each of fabrics 4 and 5 together.

Use four squares each of fabrics 5 and white together.

Place one 3.1/2" white square in opposite corners of 6.1/2" square of fabric 1, draw a line along the diagonal. Sew on the marked, trim a 1/4" from the seam and

press then repeat on the other two remaining corners.

Lay the patchwork pieces out as shown.

Sew the pieces together across each row and sew the rows to each other to complete the block. Make three of these. Sew them together in one row of three.

Finishing the Festive Friends Quilt

For the border sew the two 23.1/2" lengths of fabric 3 to the sides of the quilt and sew the two 58.1/2" strips to the top and bottom.

For the backing fabric you will need 62" x 27" of both backing fabric 1 and wadding.

For the binding, sew the four strips of fabric 2 together to give one very long strip.